



TECHNICAL FILE

VERTIRAIL



Distributed by

Vertical rail system

VERTIRAIL

PRODUCT BENEFITS

The Vertirail vertical rail system is a personal fall protection solution designed to secure vertical structures (ladders, masts, stacker cranes, etc.) and offers incomparable fluidity of movement while providing continuous protection for operators.

Fluidity

Perfectly smooth traffic flow on both ascents and descents

Design

Meticulous finishes and various anodising options available

Ease of use

use

Simultaneous use of the system: 3 users 3 metres apart

Certified with absorber with sternal connection, for vertical use

Practical

Can be installed directly on ladder rungs

Safety

Load capacity: 150kg maximum (including user & tools)

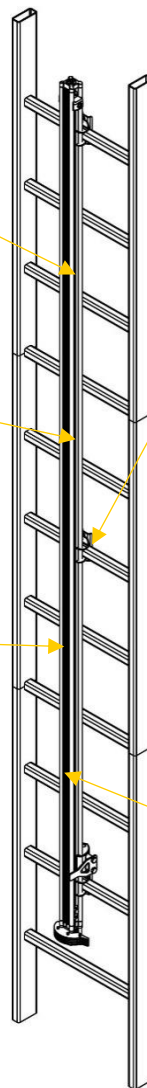



Distributed by

Vertical rail system

VERTIRAIL

PRESENTATION

VERTIRAIL is a unique solution for continuously securing all types of vertical structures.

TECHNICAL SPECIFICATIONS

- Rail material: aluminium 6060 T5
- Runner materials: aluminium alloy body, integrated shock absorber and carabiner
- RCBV runner: can be used on structures at 15° to the side and to the front.

A simple downward pull automatically locks the carriage in position.

COMPLIANCE

- EU Regulation 2016/425
- EN 353-1 + A1 : 2017
- EU type-examination certificate issued by :
APAVE SA (N°0082) - 6 RUE DU GÉNÉRAL
AUDRAN - 92412 COURBEVOIE CEDEX -
France
- Production monitoring carried out by :
APAVE SA (N°0082) - 6 RUE DU GÉNÉRAL
AUDRAN - 92412 COURBEVOIE CEDEX -
France
- Download the WVRCBV declaration of
conformity via this QR Code



REMINDER OF STANDARDS

Only when it is technically impossible to provide collective protection can individual protection against falls from height be considered (French Labour Code R4323-61).

Personal protective equipment can also be used as a complement to collective protection. The use of this type of protection imposes organisational constraints, in particular:

- defining, installing and choosing the type of equipment (lifeline, anchorage point, etc.),
- work with at least two people,
- definition of an emergency response plan,
- installation and use instructions,
- staff information and training,
- periodic inspections,
- weather conditions.

As a reminder, extract from recommendation R430 - INRS/CNAMTS:

For buildings to be constructed of any kind, technical provisions to facilitate the prevention of falls from height during subsequent work on the building must be provided for at the design stage.

The ground of technical impossibility cannot therefore be accepted, as it is now up to the project owner to modify his project so that no situation remains that cannot be properly resolved, at least, by the implementation of collective protection.



Distributed by



DELTA PLUS SYSTEMS

DECLARATION OF CONFORMITY

Delta Plus Systems declares that this product complies with the following regulations:

Identification of the PPE object of the declaration:

Mobile fall arrest device **WVRCBV** on **VERTIRAIL** support

Designation:

WVRCBV unidirectional mobile fall arrester and its **VERTIRAIL** rigid belay support

Specifications:

WVRCBV Mobile fall arrester on belay support in aluminum rail, consisting of a body with cam locking system, an energy dissipator, a carabiner and a keying device

The PPE is also identifiable by the following means:

- The product picture
- Each PPE carries the name on this declaration of conformity.
- Each PPE carries a batch number. For any further information, please contact us. Our organization, based on this batch number, allows us to ensure the traceability of the PPE.



EU DECLARATION OF CONFORMITY

This declaration of conformity is issued under the unique responsibility of the manufacturer.

The object of the declaration identified above is in conformity with the relevant Union harmonization legislation: EU 2016/425 Regulation, with its requirements and with the harmonized standards:



REGULATION (EU) 2016/425

EN353-1:2014 + A1:2017 Personal fall protection equipment — Guided type fall arresters including an anchor line

Notified body which performed the EU Type- examination and issued EU type-examination certificate:

N°0082 0588 160 01 25 0025

0082 - Apave Exploitation France SAS - 6 Rue du Général Audran - 92412 COURBEVOIE cedex - FRANCE

The PPE is subject to the conformity assessment procedure to type based on quality assurance of the production process under surveillance of the notified body:

0082 - Apave Exploitation France SAS - 6 Rue du Général Audran - 92412 COURBEVOIE cedex - FRANCE

Bernin, 07/02/2025

Signed for and on behalf of

Delta Plus:

David GUIHO

R&D, Marketing & Communication

Manager

DELTA PLUS SYSTEMS Parc Technologique - 691, Chemin des Fontaines - Cidex 8F - 38 190 Bernin - France
Tél. : +33 (0)4 76 13 12 15 -E-mail : systems@deltaplus.fr
S.A.S au capital de 40.950Euros - RCS Grenoble 430 115 766 - NTVA Intracommunautaire : FR 54 430 115 766



Distributed by

Vertical rail system

VERTIRAIL

COMPLIANCE

The Vertirail system complies with standard

EN 353-1 + A1 : 2017

EU Regulation 2016/425

EU type-examination certificate issued by :
EU type examination certificate issued by:
Certificado de examen UE de tipo expedido por :
EU - Baumusterprüfbescheinigung ausgestellt von :
Certificato di esame UE del tipo rilasciato da :
Certificado de exame UE de tipo emitido por :

APAVE SA (N°0082) - 6 RUE DU GÉNÉRAL
AUDRAN - 92412 COURBEVOIE CEDEX -
France

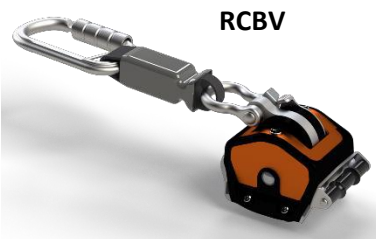

RCBV

One-way blocking carriage
Uni-directional self-locking trolley
Carro bloqueador unidireccional
Unidirektionaler Schienengleiter mit Blockiersystem
Carro bloqueador unidireccional

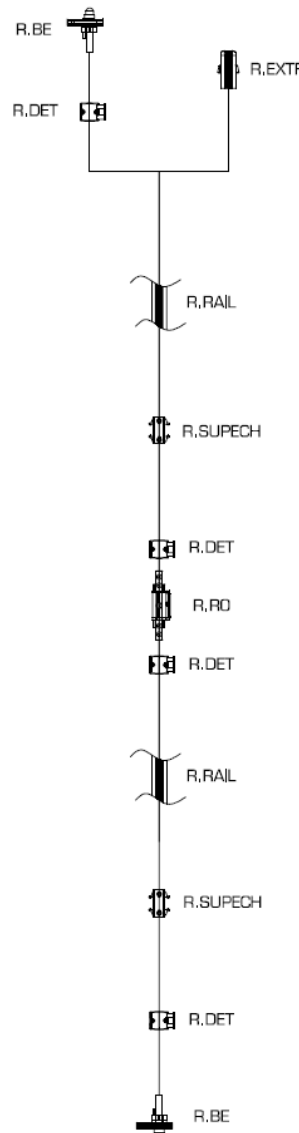



Distributed by

Vertical rail system

VERTIRAIL

SIGNAGE & MARKING

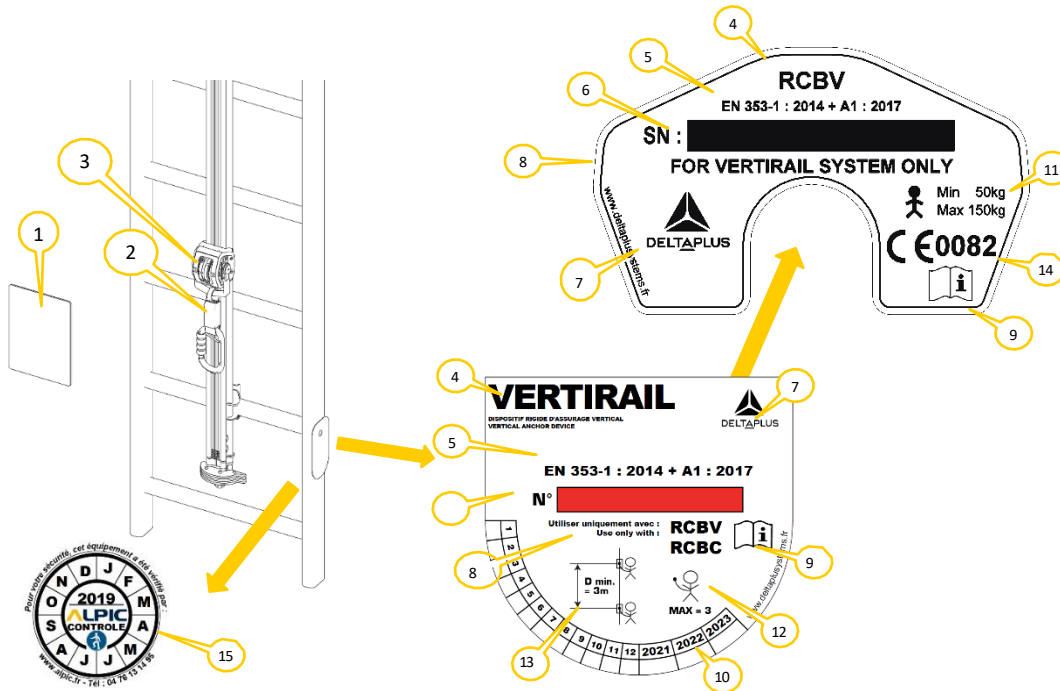

	FR	EN	ES	DE	I	PT
1	Port EPI obligatoire	Wearing mandatory PPE	Uso obligatorio de PPE	Obligatorischer EPI-Port	Porta EPI obbligatoria	Porta obrigatória do EPI
2	Date de fabrication & date de péremption du produit	Date of manufacture Product expiry date	Fecha de fabricación Fecha de vencimiento del	Herstellungsdatum Ablaufdatum des Produkts	Data di produzione Data di scadenza del prodotto	Data de fabricação e validade do produto
3	Sens d'utilisation	Direction of use	Dirección de uso	Nutzungsrichtung	Direzione d'uso	Direção de uso
4	RCBV = Référence commerciale du produit	RCBV = Sales product reference (Delta Plus)	RCBV = Referencia comercial del producto	RCBV = Produktreferenz kaufmännisch	RCBV = Riferimento commerciale del prodotto	RCBV = Referência comercial do produto
5	Norme auquel l'équipement est conforme	Standard to which the product conforms	Norma a la que se ajusta el producto	Standard, dem das Gerät entspricht	Standard a cui l'apparecchiatura è	Padrão ao qual o equipamento está em conformidade
6	Numéro de série	Serial number	Número de serie	Seriennummer	Numero di serie	Número de série
7	Nom du fabriquant	Manufacturer's name	Nombre del fabricante	Name des Herstellers	Nome del produttore	Nome do fabricante
8	Composant compatible	Compatible component	Componente compatible	Kompatible Komponente	Componente compatibile	Componente compatível
9	Pictogramme invitant à lire la notice	Pictogram inviting to read the instructions	Pictograma que invita a leer las instrucciones.	Piktogramm, das zum Lesen der Anweisungen einlädt	Pittogramma che invita a leggere le istruzioni	Pictograma convidando para ler as instruções
10	Date de première mise en service	Date of first commissioning	Fecha de primera puesta en servicio.	Datum der ersten	Data della prima messa in servizio	Data d oprimeiro comissionamento



Distributed by

Vertical rail system

VERTIRAIL

11	Charges assignées min et max	Loads assigned min and max	Cargas asignadas mín. Y máx.	Belastungen zugewiesen min und max	Carichi assegnati min e max	Cargas atribuídas min e max
12	Nombre maximum de personnes autorisées à se connecter	Maximum number of people allowed to connect simultaneously:	Número máximo de personas permitidas para conectarse	Maximale Anzahl von Personen, die gleichzeitig eine Verbindung herstellen dürfen:	Numero massimo di persone che possono connettersi	Número máximo de pessoas com permissão para se
13	Distance de sécurité entre deux utilisateurs	Security distance between two users	Distancia de seguridad entre dos usuarios.	Sicherheitsabstand zwischen zwei Benutzern	Distanza di sicurezza tra due utenti	Distância de segurança entre dois usuários
14	Organisme notifié en charge du contrôle de la production	Notified body in charge of the control of the production	Organismo notificado a cargo del control de la producción	Benannte Stelle, die für die Produktionskontrolle zuständig ist	Organismo notificato responsabile del controllo della produzione	Organismo notificado o encarregado do controle da
CE0082 APAVE SA : APAVE SA (0082) - 6 RUE DU GÉNÉRAL AUDRAN 92400 COURBEVOIE CEDEX FRANCE						
15	Date de l'inspection périodique	Date of periodic inspection	Fecha de inspección periódica	Datum der periodischen Überprüfung	Data dell'ispezione periodica	Data da inspeção periódica

OPERATING PRINCIPLE

1

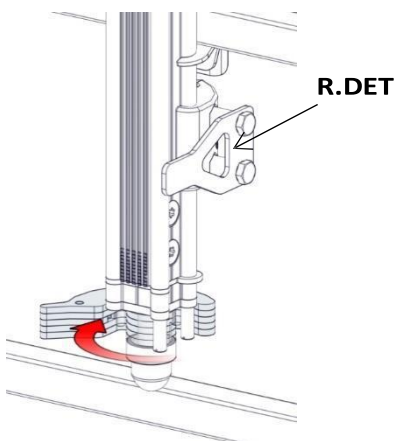

2

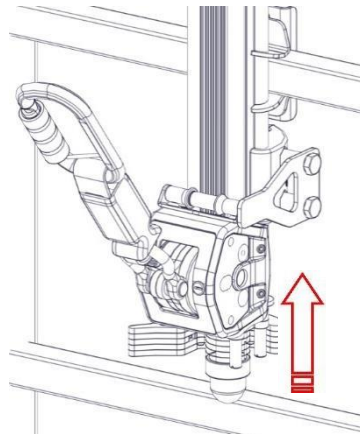

3

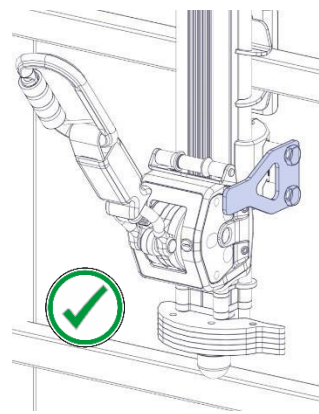

4

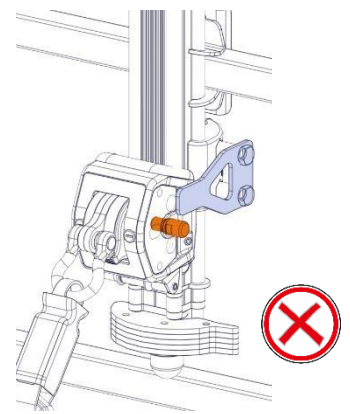



Distributed by

Vertical rail system

VERTIRAIL

5

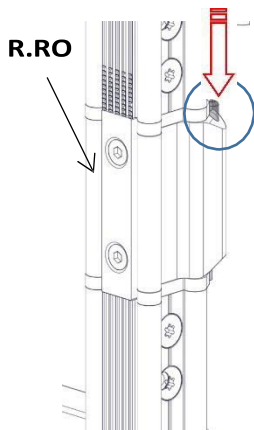

6

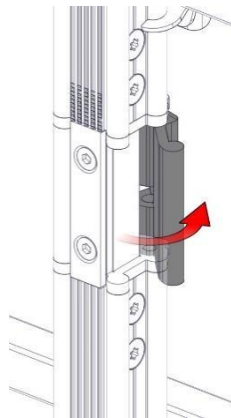

7

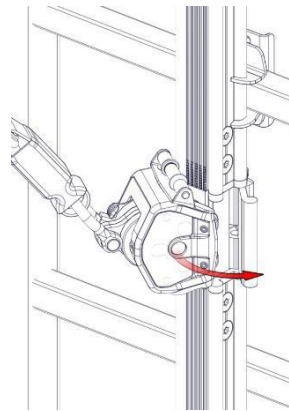

8

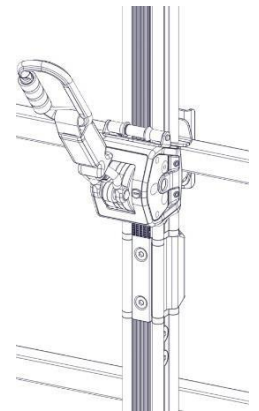

9

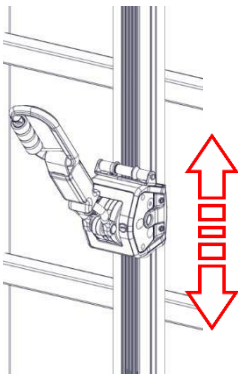

10

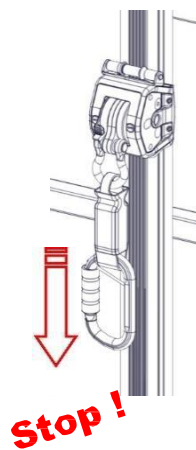

11

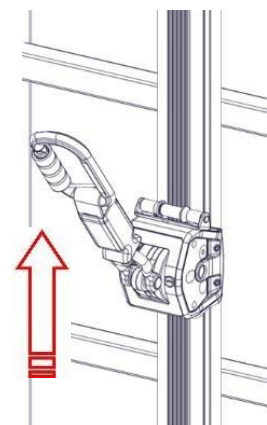



Distributed by

Vertical rail system

VERTIRAIL

INFORMATION

The system is certified for use on any rigid vertical Delta Plus Systems structure, aluminium or steel ladders with a minimum strength of 12kN and which do not deviate from the vertical by more than 15° laterally and forwards. Any other use is prohibited and may be dangerous.

These instructions are intended for users of the RCBV fall arrester and its VERTIRAIL support. It must be read and understood by everyone before using the product. If you have any doubts or problems of understanding, or if a problem arises which is not covered in this document, please contact your Delta Plus Systems representative or the Delta Plus Systems technical department directly. This manual must always be available and accessible to the user. It is essential for the user's safety that, if the product is resold outside the first country of destination, the reseller supply the instructions for use, maintenance, periodic inspections and repairs, written in the language of the country where the product is to be used. Any activity at height is dangerous and may cause accidents, serious injury or death. You are responsible for practising and learning the techniques for using the appropriate equipment. Before using the product, you must therefore read and understand all the information contained in the instruction manual. Failure to heed any of these warnings could result in serious injury or death. For safety reasons, the user must be in good health and not under the influence of medication, alcohol or drugs. Workers using personal protective equipment must receive appropriate training.

Instructions for use & technical description

The PPE consists of a mobile fall arrester, reference RCBV, and a Delta Plus Systems vertical rail-type belay support, reference VERTIRAIL. The product is certified to EN 353-1 + A1 2017.

The temperature of the working environment must be above -30°C.

This device is used to move and protect against falls from height, both upwards and downwards.

The user must connect his harness to the runner via the sternal attachment point using the connector integrated into the WVRCBV, which complies with EN 362. The connection incorporates a textile energy absorber to limit the impact force in the event of a fall. CAUTION The length of the connection element must not be extended or shortened, for example by adding or removing a connector.

The carriage is connected and disconnected at the ends of the rail (1 -2) or at an opening part ref. WVRRO (5-8). These actions must be carried out in a safe position, or using a separate personal protection system.

The runner has been designed to move freely on the rail without manual intervention (8): holding the locking mechanism or handling the runner while moving may prevent it from locking in the event of a fall. Do not hold the runner.

A coding device at the ends of the rail or at the opening part prevents any incorrect installation (3-4). The carriage is locked in the event of a fall by the action of the cam on the rail (9). To release the carriage, pull the connector upwards (10).

The truck is designed to be used by a single person weighing between 50 kg and 150 kg (including tools and equipment).



Distributed by

Vertical rail system

VERTIRAIL

There is no limit to the length of the rope grab. WVREXTF or WVRBE must be fitted at all points on the rigid belay support where the mobile fall arrester could come out of the rigid belay support.

After use, never leave the runner connected to the rail, clean it (see maintenance section) then store it in the waterproof pouch supplied. Protect it from shocks, humidity and excessive temperatures (+10°C / +40°C) during transport and storage.

Rigid belay devices may not be used in rescue situations. Operations must be carried out using a separate personal protection system.

IMPORTANT - PREVENTION : **Before use**

At height, your life depends on the equipment used. Any doubts about the safety of the device should be reported to the manufacturer and to the person responsible for the installation.

A fall arrest harness conforming to EN 361 is the only body-gripping device permitted for use in a fall arrest system. A harness must be size-appropriate, correctly adjusted and fitted to the user's body size. The fall arrest harness should be properly adjusted to ensure a snug fit and should not be used if it is loose. If the harness loosens during ascent or descent, it should be readjusted correctly from a safe location. The durability of the support must be checked in accordance with use. A rescue plan must be in place to deal with any emergencies that may arise during work. In a fall arrest system it is essential to check the clearance under the user before and during use, to avoid any collision with the ground or an obstacle during the fall.

In a fall arrest system, it is essential to check the clearance under the user before and during use, to avoid any collision with the ground or an obstacle during the fall.

In the VERTIRAIL system, this space must be at least 2 m. During the first 2 metres of the VERTIRAIL system, the user may not be protected against falling to the ground; extra precautions should therefore be taken when ascending or descending. The runner must not be used in the working position. If it is necessary to hold the runner in the working position, a separate system must be used.

A hazard may arise when using several pieces of equipment in which the safety function of one piece of equipment may be affected by the safety function of the other piece of equipment.

ATTENTION DANGER: please ensure that your equipment does not rub against abrasive materials or sharp parts that could damage its integrity, particularly the textile energy absorber.

As the runner is supplied with its own connector, it is not possible to change the components independently. Use only Delta Plus Systems parts to ensure compatibility when assembling the VERTIRAIL system.

Control - Points to check

Check that the instructions for using the safety rail are clearly displayed on the panel provided. Make sure that the product markings are legible.

Check that your fall arrest system complies with and is compatible with those recommended for use with the VERTIRAIL system.



Distributed by

Vertical rail system

VERTIRAIL

Service life - Disposal

For Delta Plus Systems products, plastics and textiles, the maximum service life is 10 years from the date of manufacture. There is no limit for metal products.

CAUTION, an exceptional event may lead you to reject a product after a single use (type and intensity of use, environment of use: aggressive environments, marine environment, sharp edges, extreme temperatures, chemicals, etc.).

A product must be scrapped when :

- ▶ It is over 10 years old and made of plastic or textile.
- ▶ He has suffered a serious fall (or strain).
- ▶ The result of the product checks is not satisfactory.
- ▶ You have doubts about its reliability.
- ▶ You don't know its full history of use.
- ▶ Its use is obsolete (changes in legislation, standards, technology or incompatibility with other equipment, etc.).

Destroy these products to prevent future use.

System warranty

The warranty begins on the date of delivery of the equipment or installation by Delta Plus Systems. It lasts for 10 years provided that annual maintenance has been carried out by a company approved by Delta Plus Systems. Delta Plus Systems warrants this product against defects in materials and workmanship. The following are excluded from the warranty: normal wear and tear, oxidation, modifications or repairs, improper storage, improper maintenance, damage due to accidents, negligence or use for which this product is not intended.

Maintenance and servicing

Any modification or addition to the equipment without the prior written consent of the manufacturer is prohibited.

Any repairs to system components must be carried out in accordance with Delta Plus Systems procedures. If in doubt about the condition of the product, replace it with an original Delta Plus Systems part.

A soiled product must be washed and rinsed with clean water, then dried. It must not be brought into contact with corrosive or aggressive materials, or stored at extreme temperatures. All chemical products and solvents can alter the resistance of the system components. If the product is likely to come into contact with these products, please let us know the exact name of the chemical components and we will respond after an appropriate study.

The condition of PPE must be checked at least every 12 months by an authorised and competent person in strict compliance with Delta Plus Systems' operating procedures. These periodic and regular examinations are necessary because the safety of the user is linked to maintaining the effectiveness and resistance of the equipment. The inspection and the results must be recorded in writing in a maintenance log using the identification and inspection sheet supplied by Delta Plus Systems. Delta Plus Systems can also help you check, inspect and maintain your permanent fall arrest and PPE safety systems. You can also ensure that your teams are fully conversant with the use of these fall arrest solutions and with the basic concepts they need to know to work safely at height, by offering them comprehensive, customised training courses run by our training centre.



Delta Plus Training -
691, Chemin des
Fontaines - Cidex 8F -
38190 BERNIN - France



Distributed by

Vertical rail system

VERTIRAIL

GENERAL NOMENCLATURE



1

Blocking runner
WVRCBV



2

Belay rail
WVRRAIL
Available in lengths of : 1, 1.5 and 3m. Material: 6060 T5 aluminium. Anodised on request.

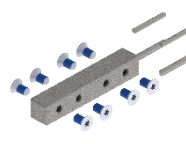

3

Splint
WVRECL
Ensures rail alignment
4 A4 screws pre-coated with threadlocker

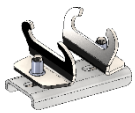

4

Ladder rail support
WVRSUPECH
Adapts to the size and rungs of the ladder
Distance between 2 supports: $1350\text{ mm} < D < 1650\text{ mm}$



5

Fixed stop
WVREXTF
Prevents the carriage from sliding off the rail - Secured with 3 self-drilling screws (A2).



6

Retractable stop
WVRBE
Enables the runner to be inserted on the rail. Closes automatically.



7

Opening splint
WVRRO
Enables the carriage to be inserted at any point on the rail and acts as a jointing plate.



8

Safety sign
WVRPS
System identification and display of normative information.



9

Manual switch
WVRAIG3D or 4D
Available in 3 or 4 directions.
Allows changes of direction without disconnection.



10

Coding device
WVRDET
Ensures that the carriage is inserted on the rail in the correct direction of use



11

Drilling tool
WVROUTP
Template for drilling the rail.





Distributed by

Vertical rail system

VERTIRAIL

TOOLS & PERSONNEL REQUIRED

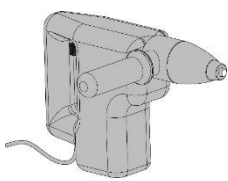

1

2

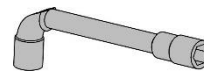

3

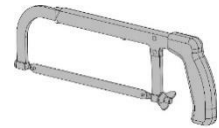

4

10 - 13



5



6

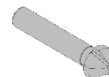

7

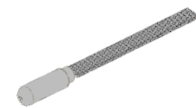

8

5 - 6

Ø 8.5

Ø 16.5

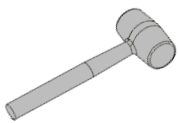

9

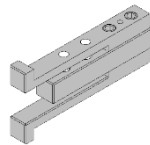

10

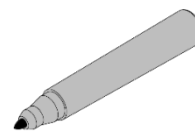

11



12

WVROUTP

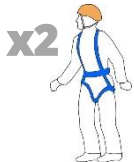

x2

13

PRE-REQUISITES

α (alpha): 0° to 15°

β (beta): 0° to 15°

γ (gamma): 0° to 75°

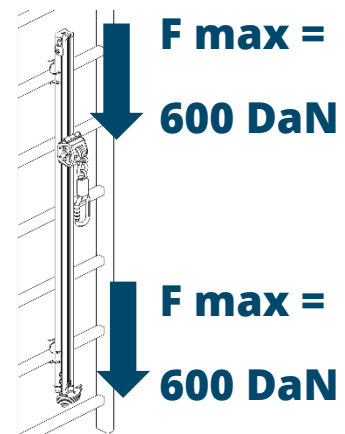
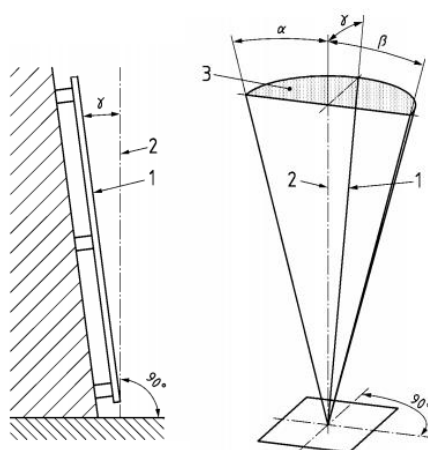



Distributed by

Vertical rail system

VERTIRAIL

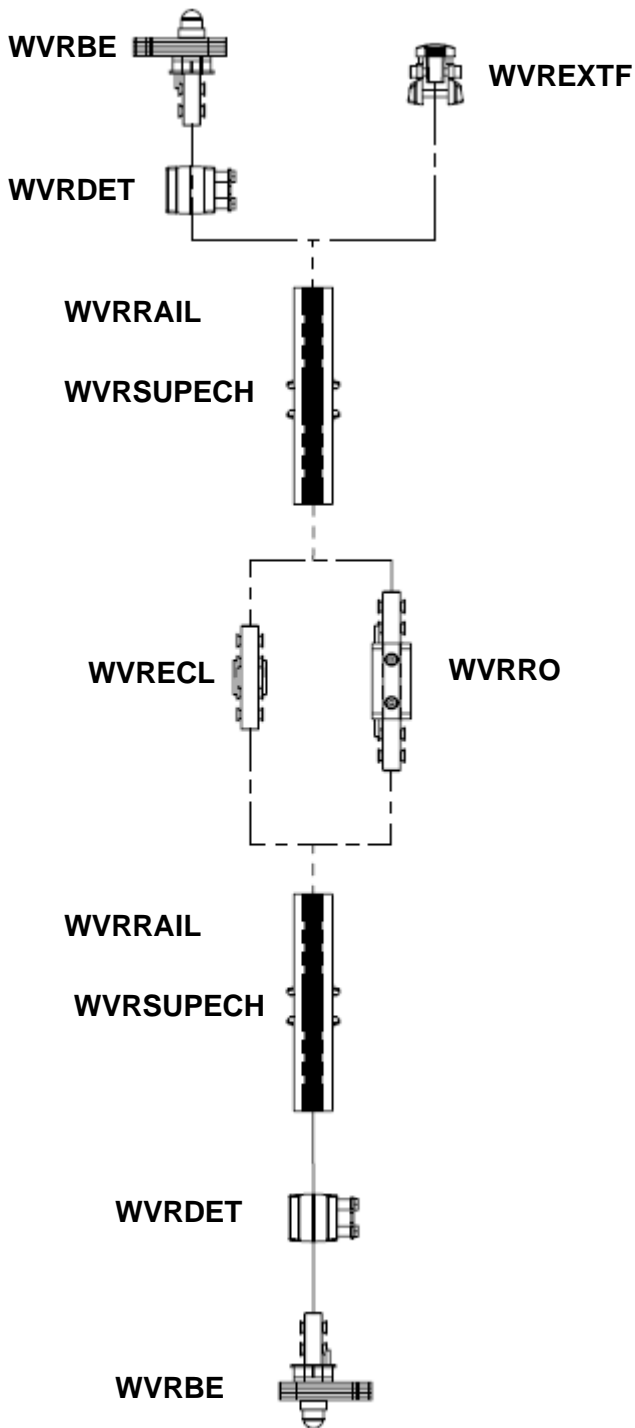

Ladder mounting

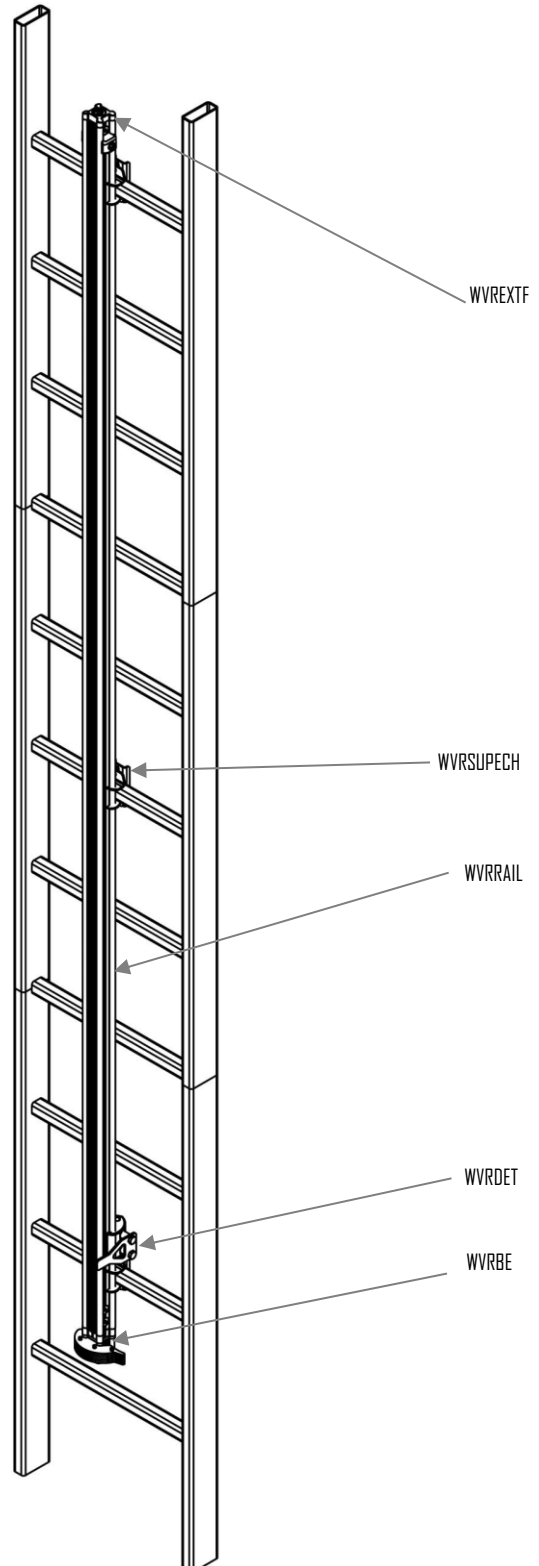



Distributed by

Vertical rail system

VERTIRAIL

ASSEMBLY OF RAIL ELEMENTS

OPENING STOP - WVRBE



1

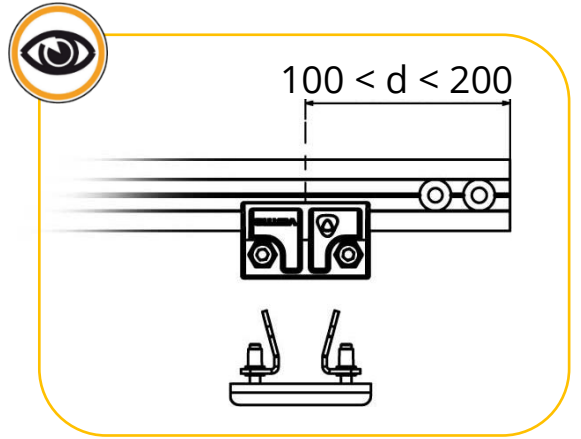
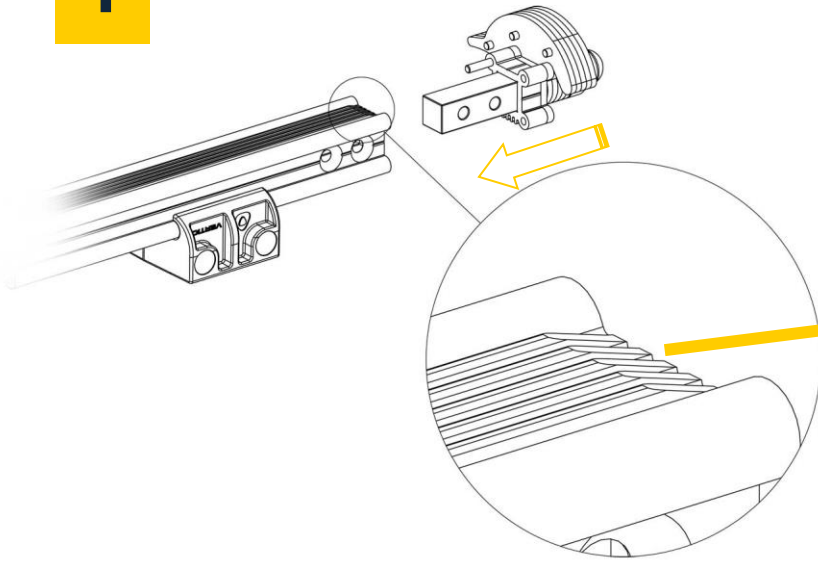

2

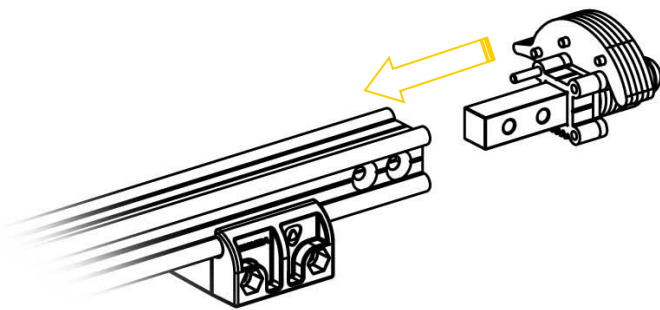

3

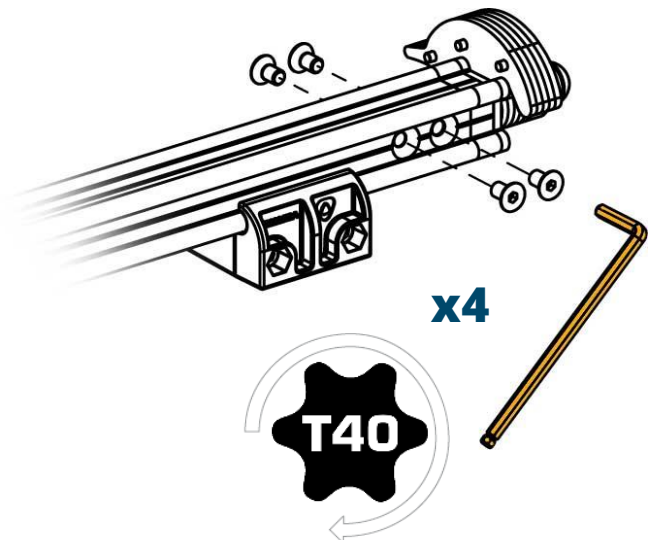



Distributed by

Vertical rail system

VERTIRAIL

OPENING STOP - WVRBE

4

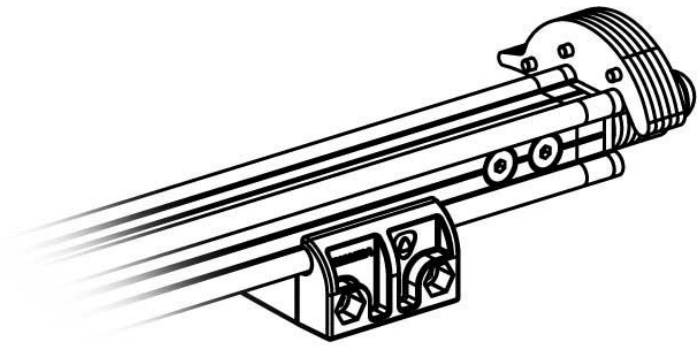

5

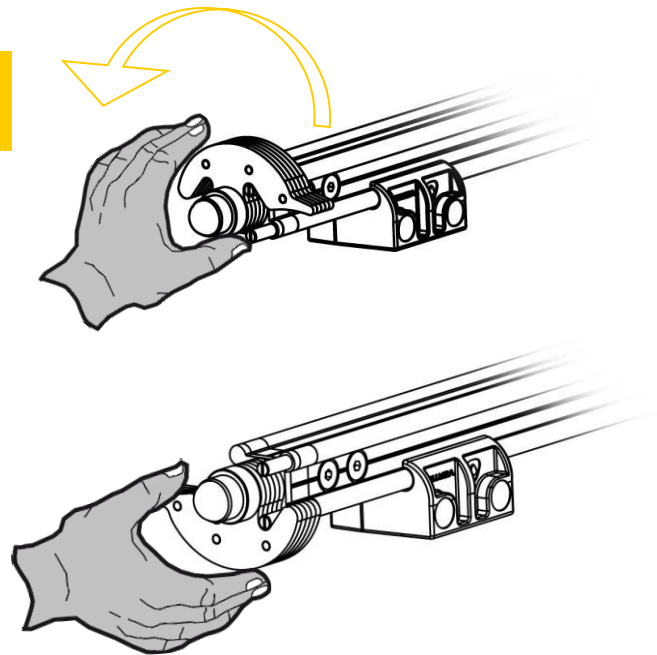

6

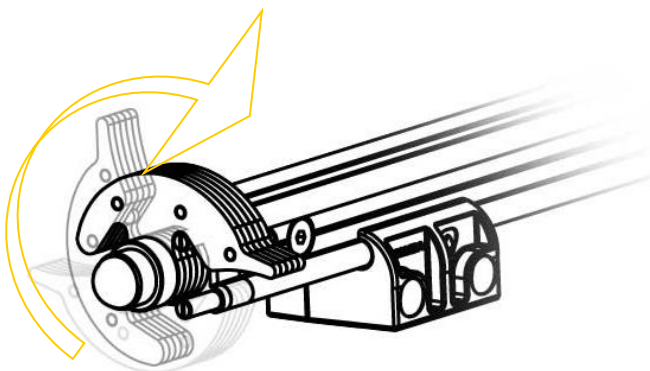

CLICK



Distributed by

Vertical rail system

VERTIRAIL

DECEPTION - WVRDET



1



2

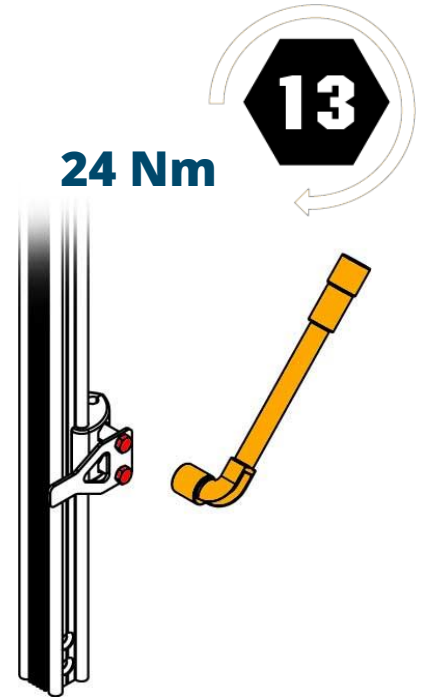

3

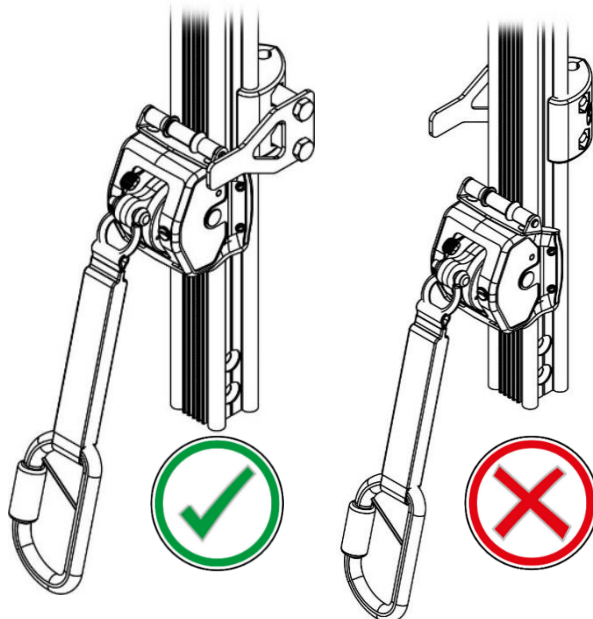



Distributed by

Vertical rail system

VERTIRAIL

ECLISSE - WVRECL

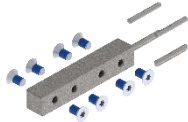

1

2

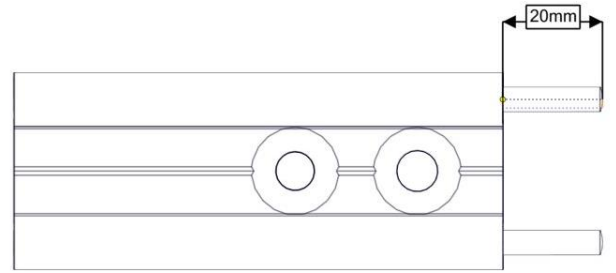
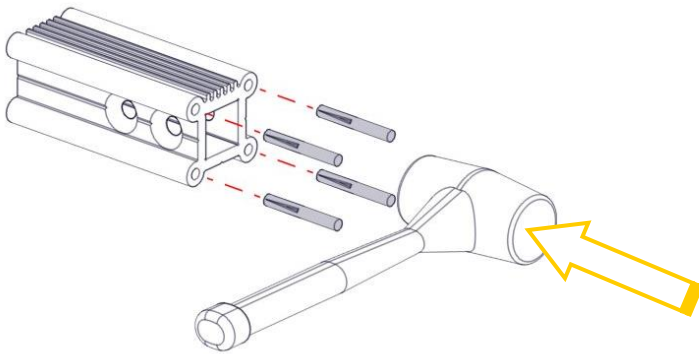

3

4

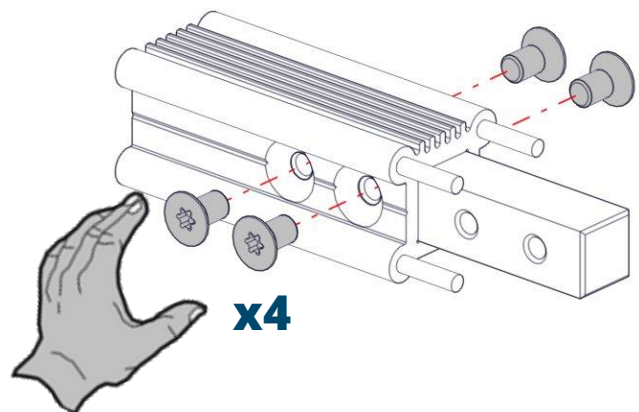
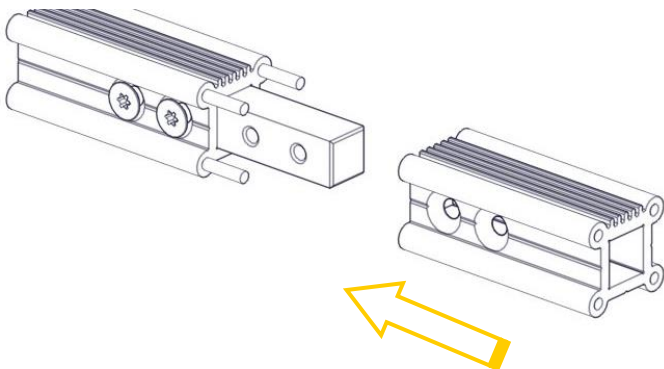



Distributed by

Vertical rail system

VERTIRAIL

ECLISSE - WVRECL

5

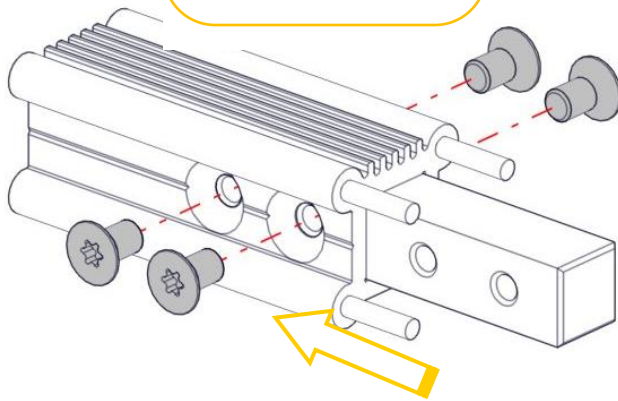
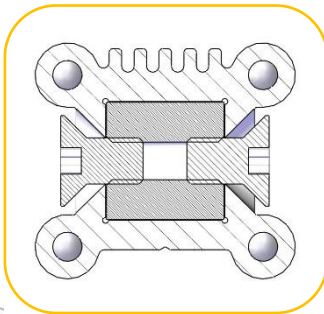

6

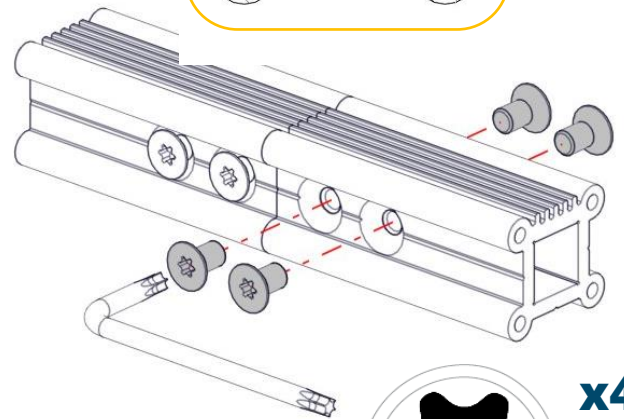
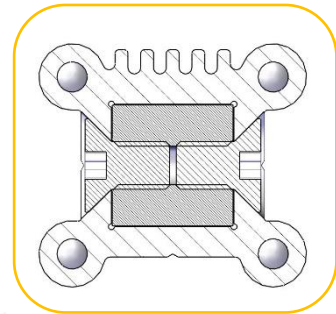

7

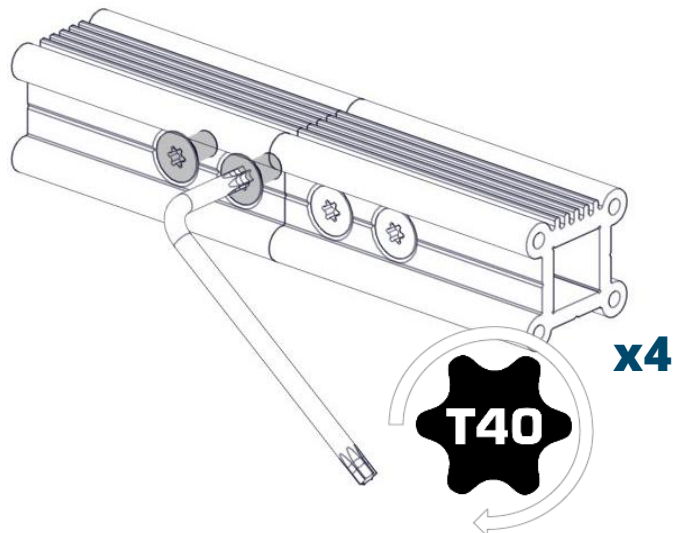
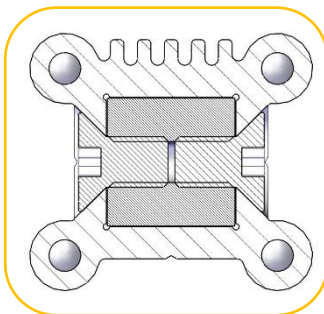

x4

T40

x4

T40



Distributed by

Vertical rail system

VERTIRAIL

FIXED STOP - WVREXTF



1

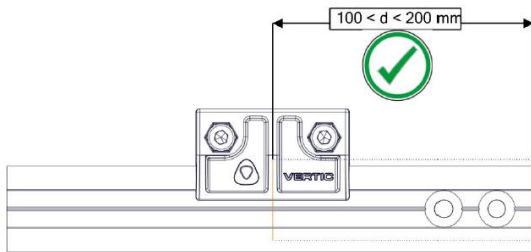

2

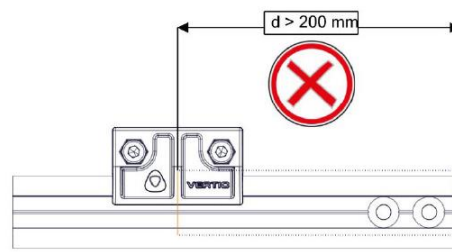

3

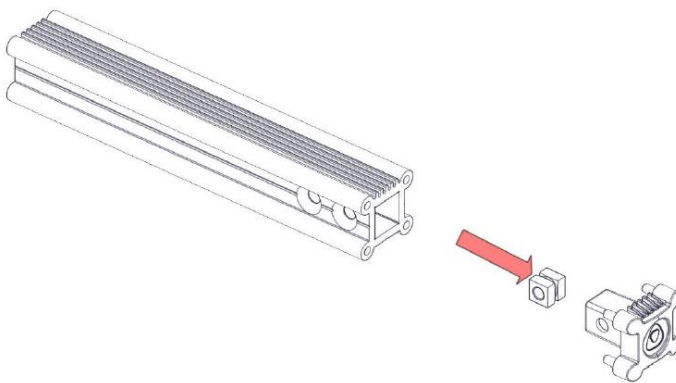

4

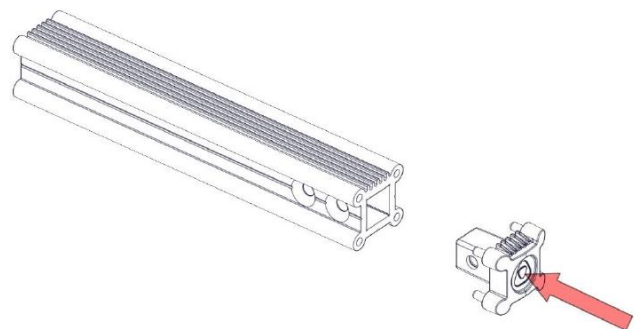



Distributed by

Vertical rail system

VERTIRAIL

FIXED STOP - WVREXTF

5

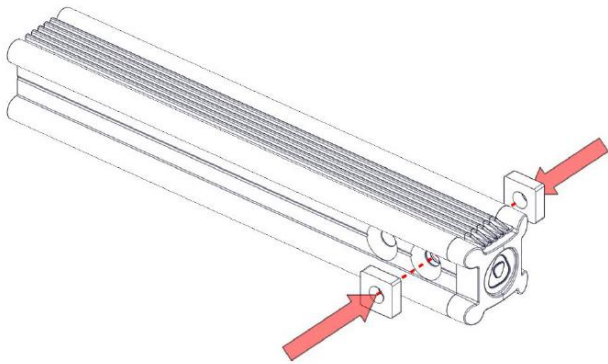

6

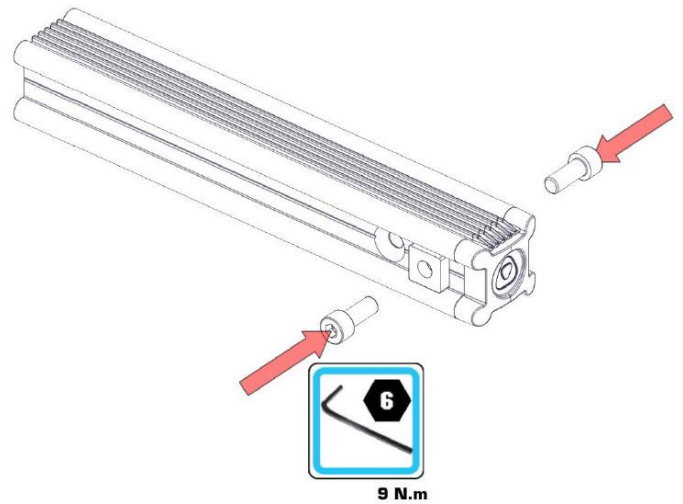

7

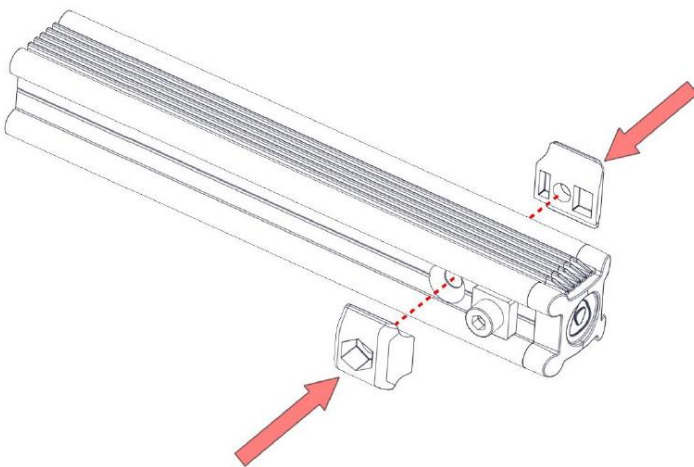

8

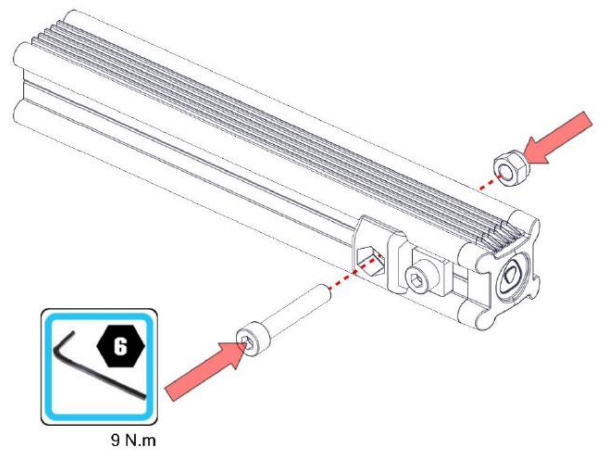



Distributed by

Vertical rail system

VERTIRAIL

RAIL DRILLING TOOL - WVR0UTP

1

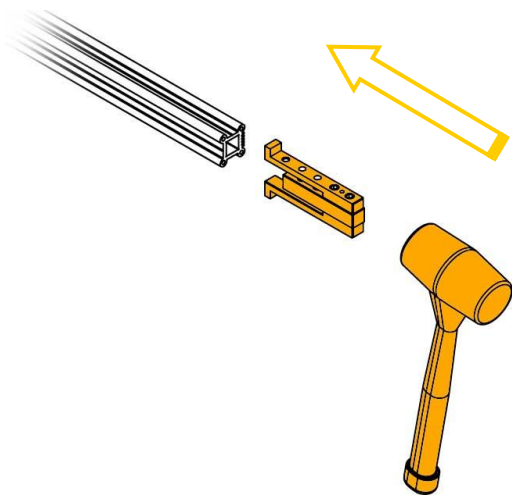

2

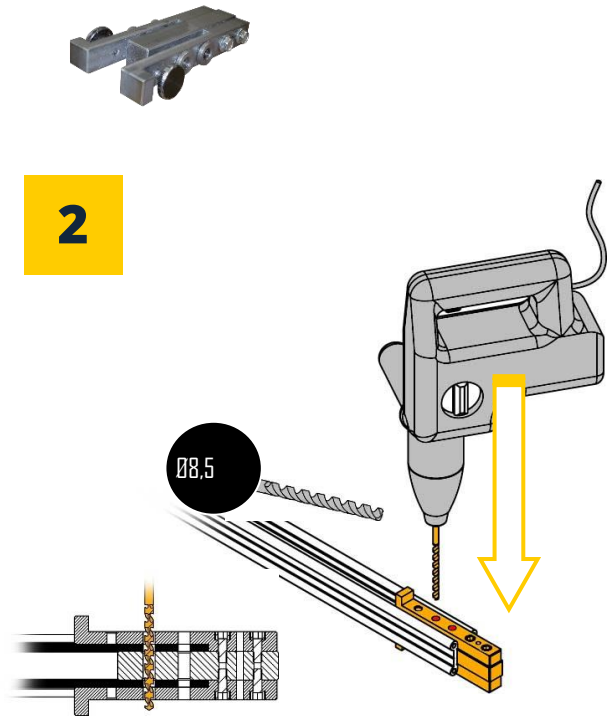

3

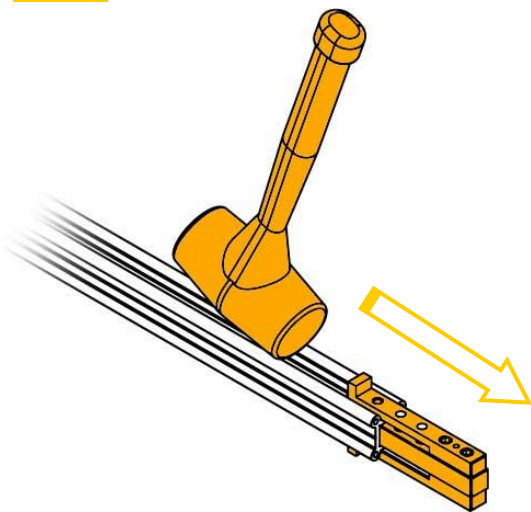

4

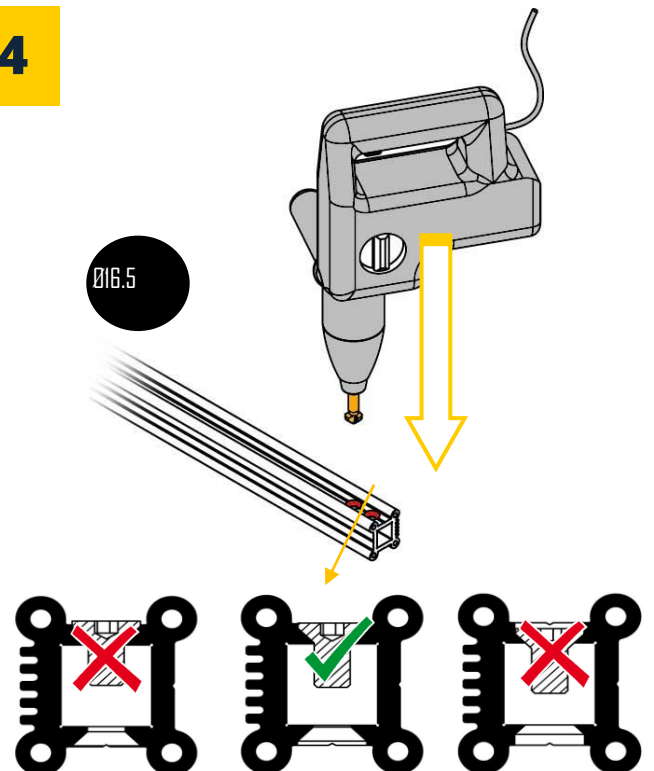



Distributed by

Vertical rail system

VERTIRAIL

SAFETY PANEL - WVRPS



1

ALTIRAIL

ABSURAGE RIGIDE HORIZONTAL
HORIZONTALE ANCHOR DEVICE
www.deltaplusystems.fr



EN 795-D : 2012 / TS 16415 : 2013



N° [Redacted]

Utiliser uniquement avec : RCF2 / RCF3 / RCBC
Use only with : RCF2 / RCF3 / RCBC

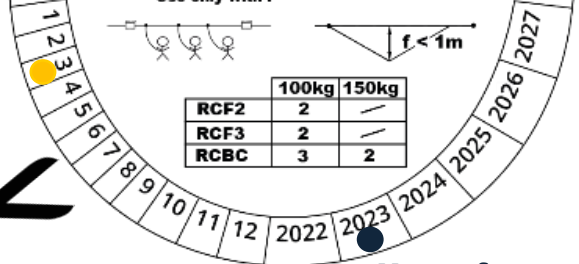

Month of installation



Year of installation

2

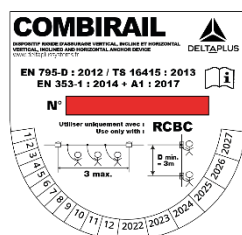
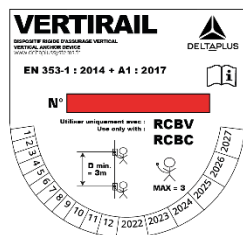
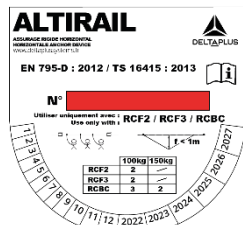
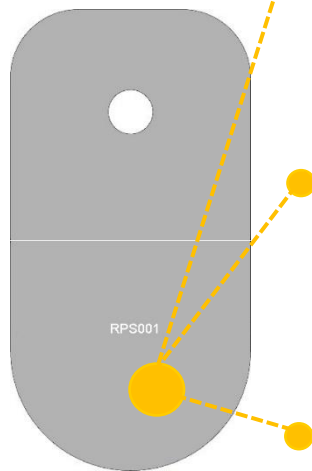

3

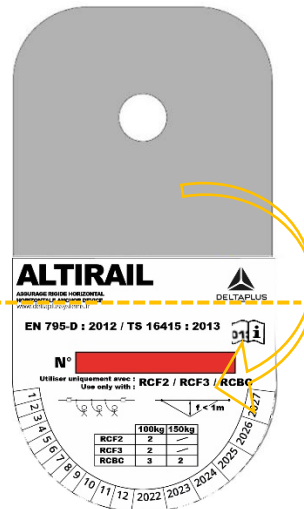



Distributed by

Vertical rail system

VERTIRAIL

SAFETY PANEL - WVRPS

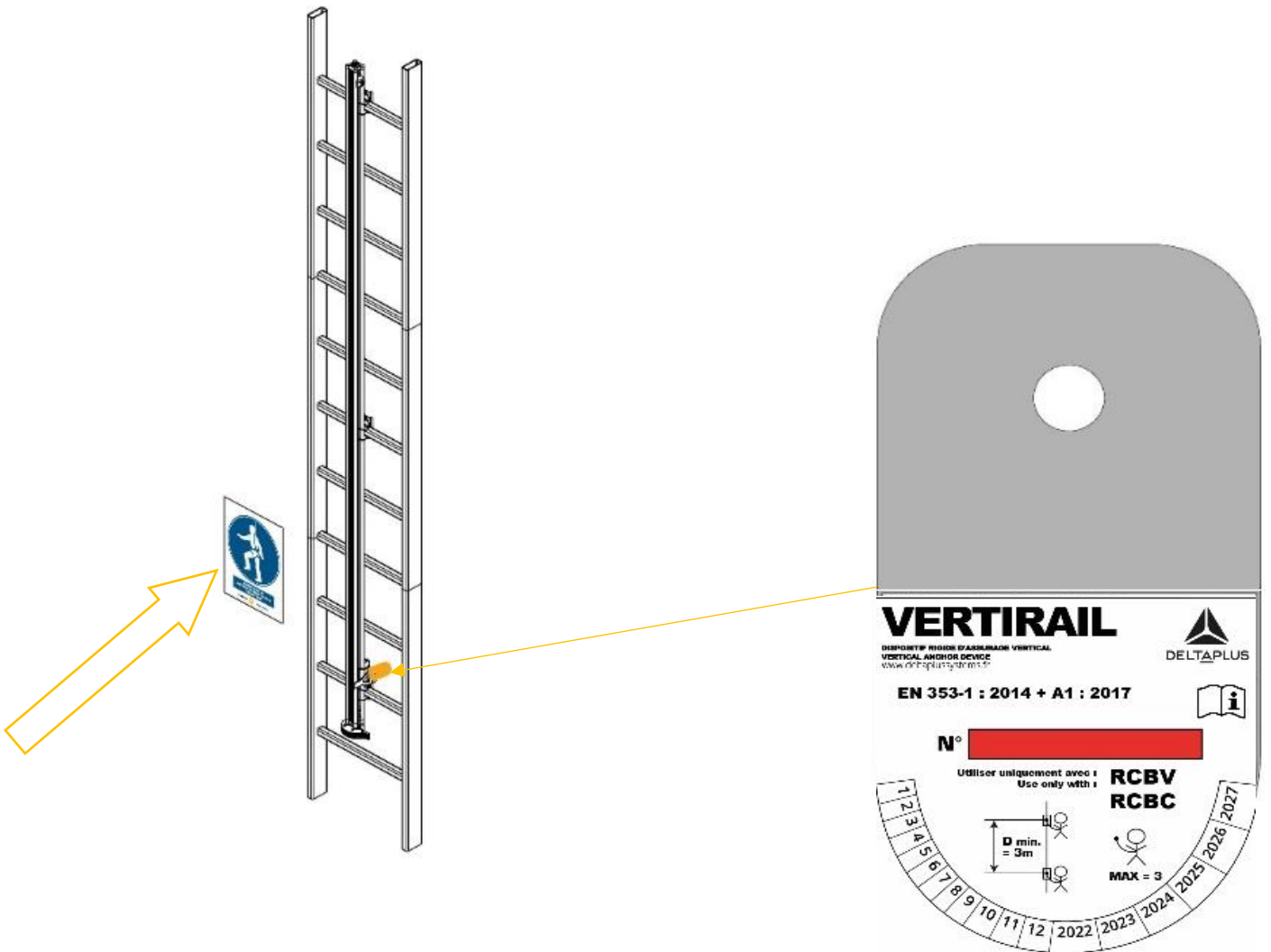



Distributed by

Vertical rail system

VERTIRAIL

RAIL SUPPORT - WVRSUPECH

1

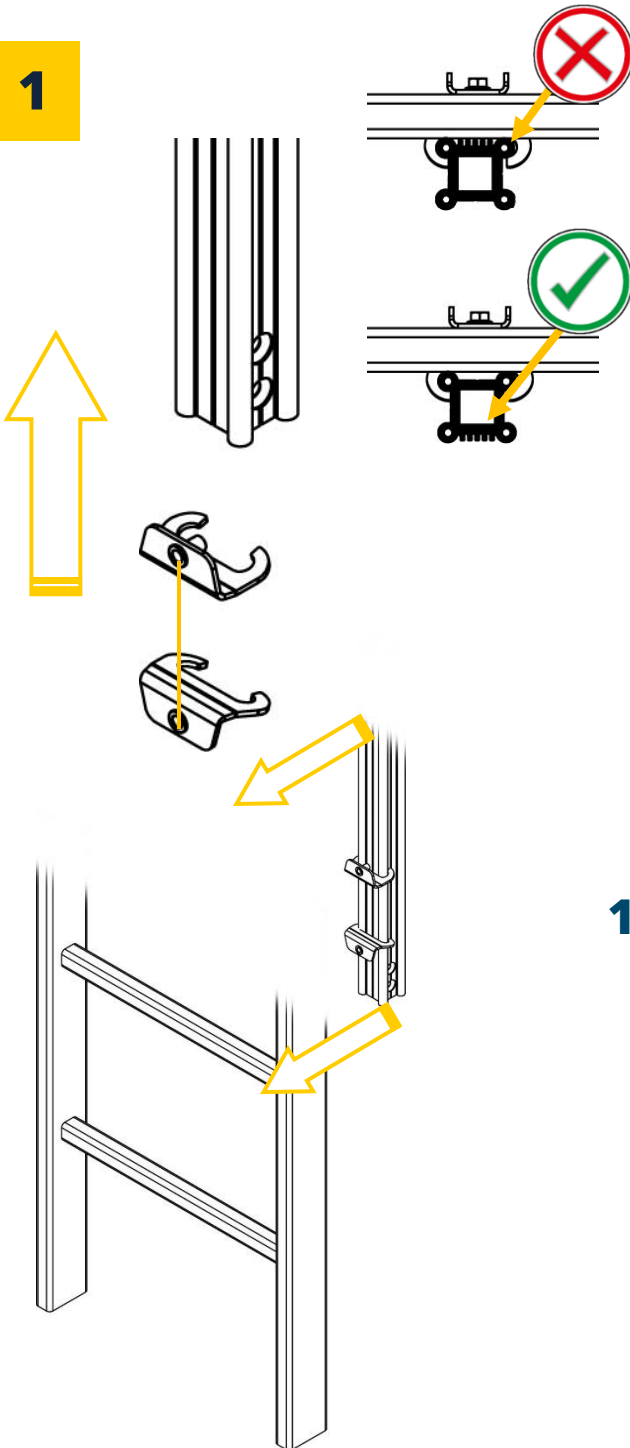

2

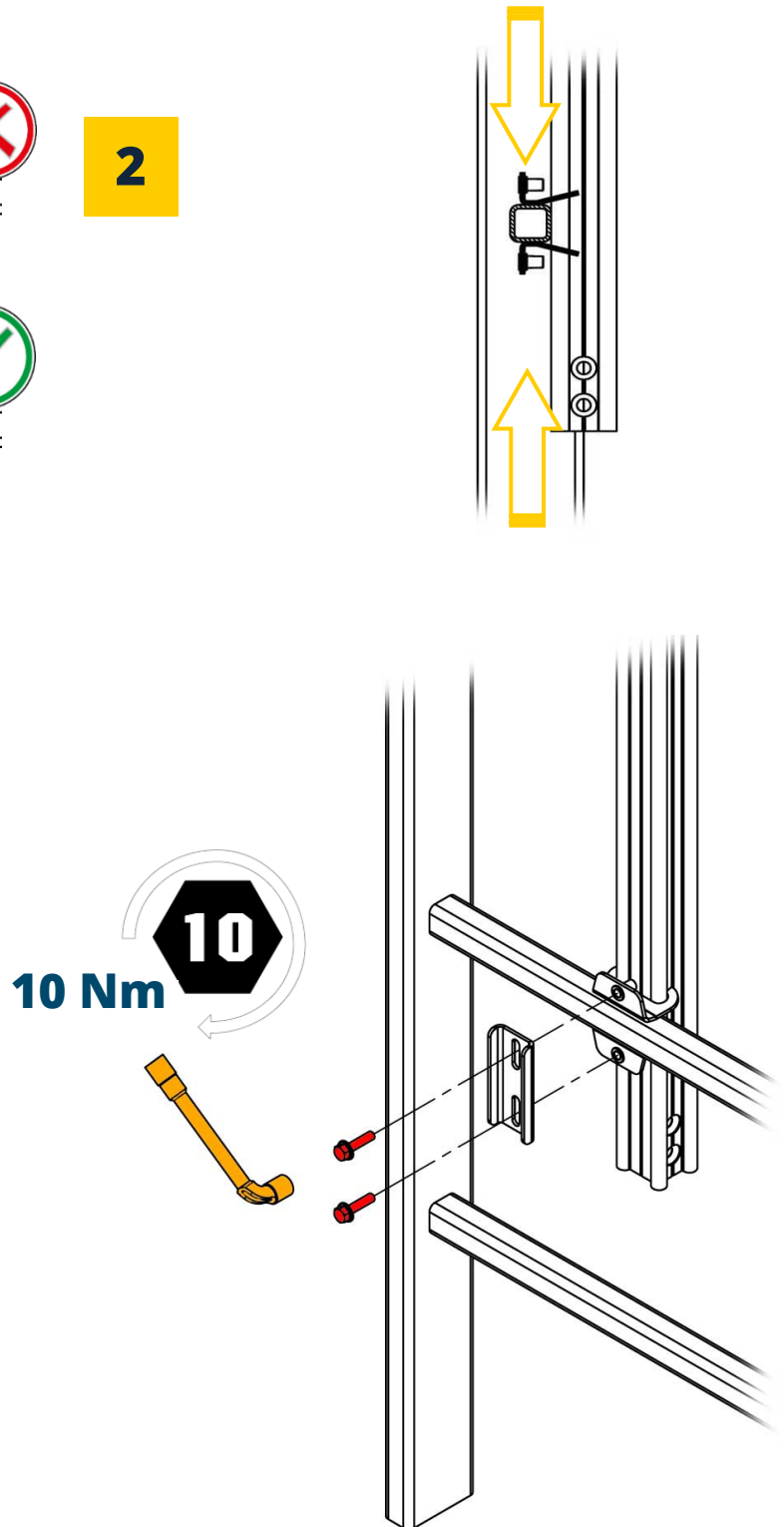



Distributed by

Vertical rail system

VERTIRAIL

LADDER MOUNTING

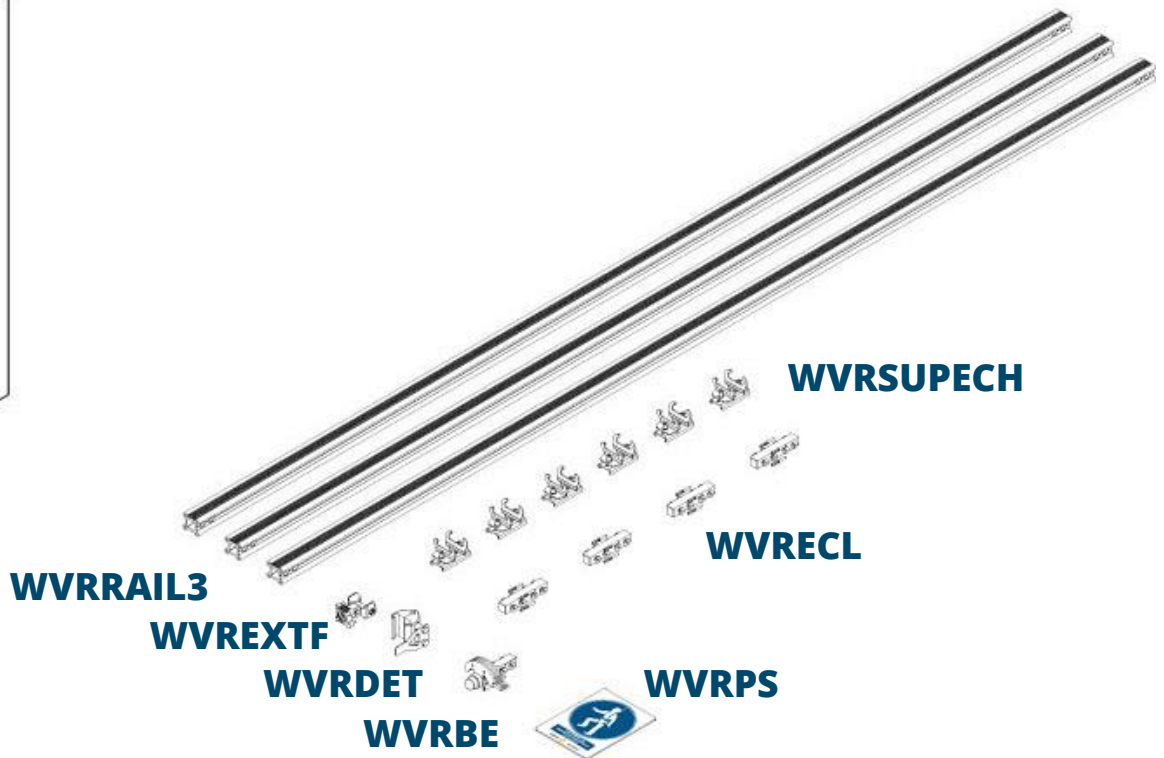
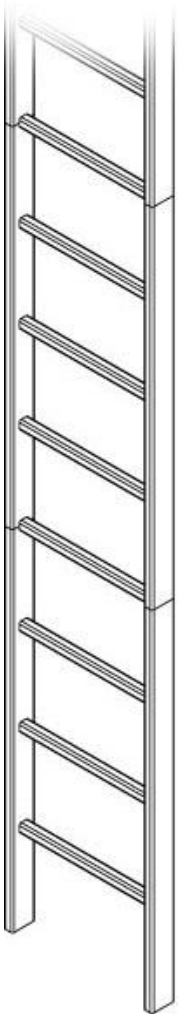



Distributed by

Vertical rail system

VERTIRAIL

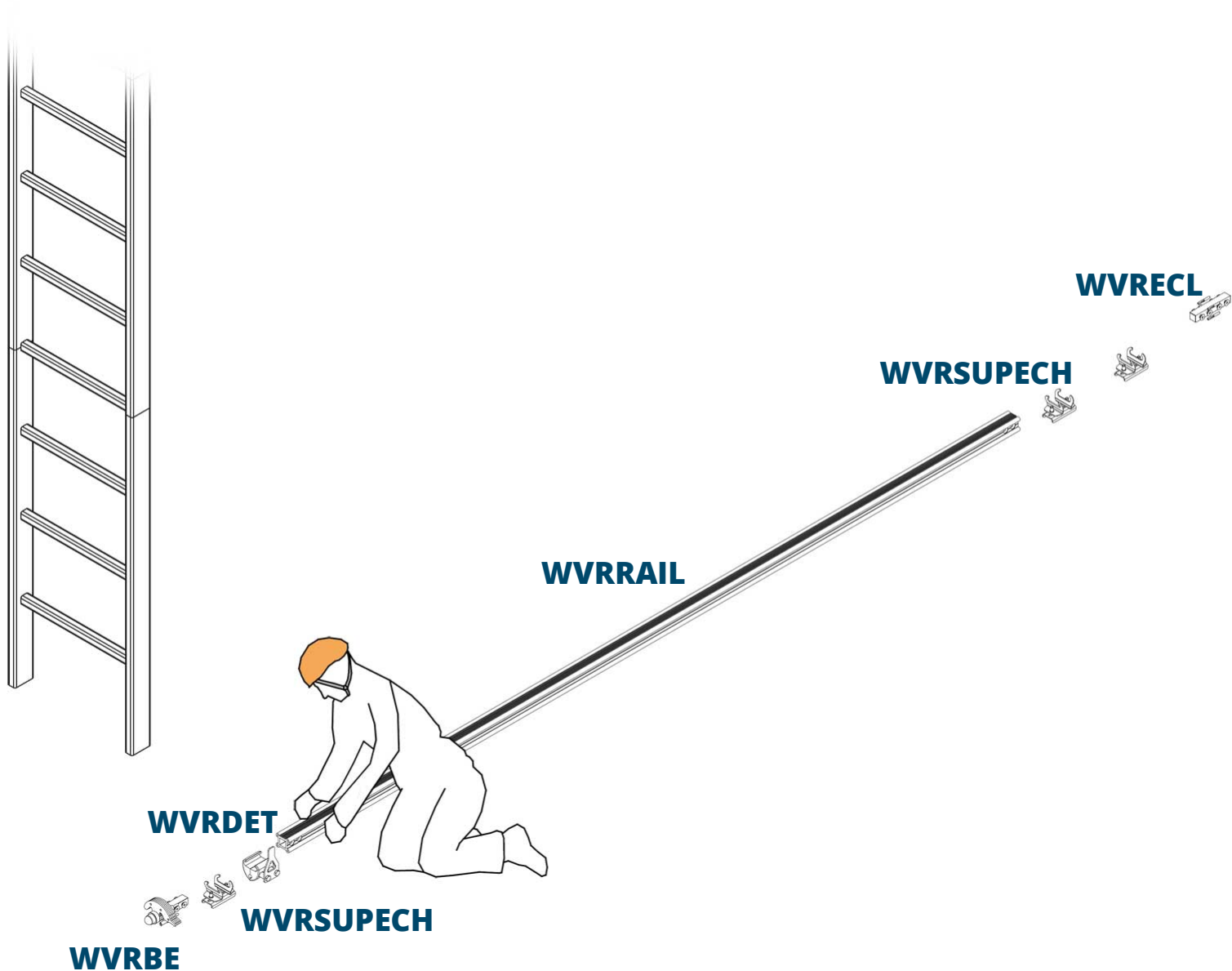



Distributed by

Vertical rail system

VERTIRAIL

1

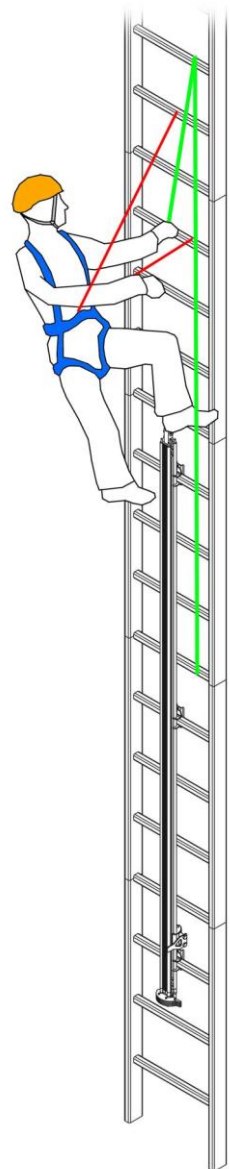
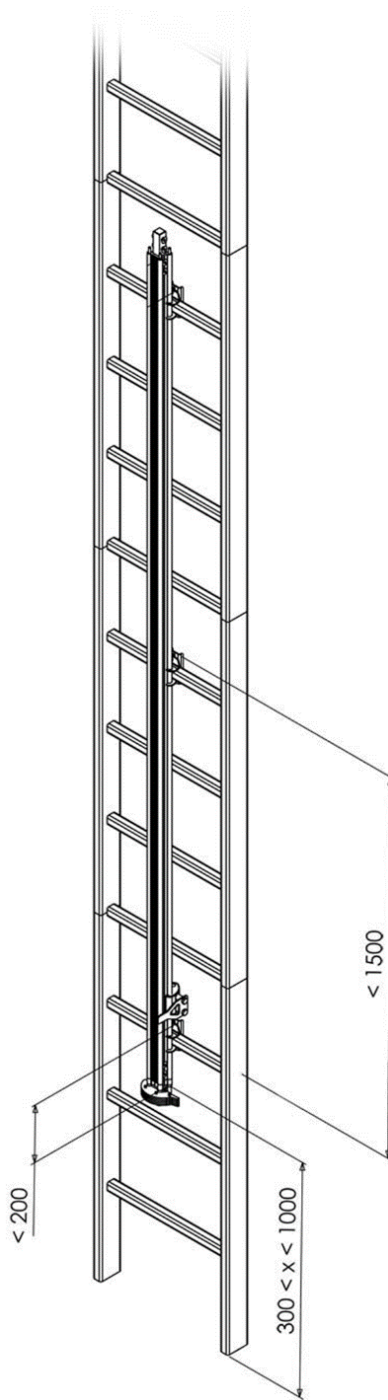
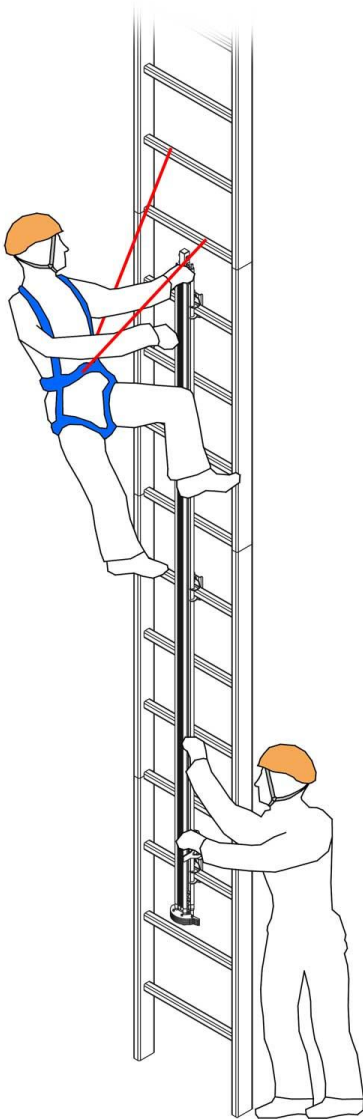



Distributed by

Vertical rail system

VERTIRAIL

2

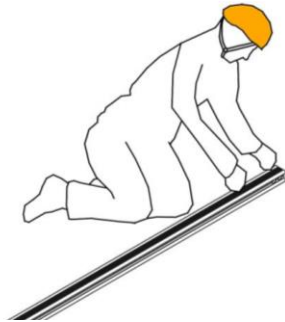

WVRECL

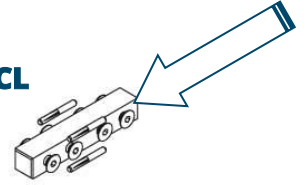

3

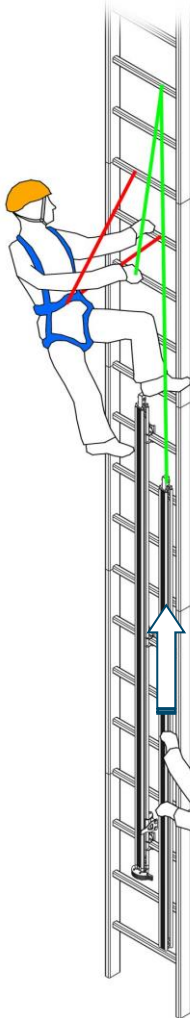

4

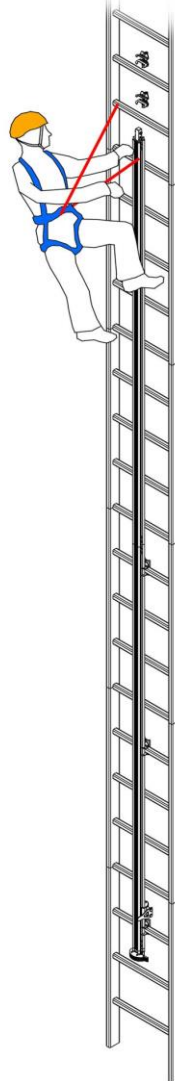

2 x
WVRSUPECH

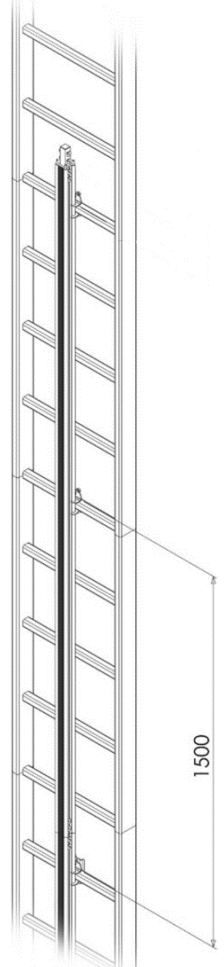
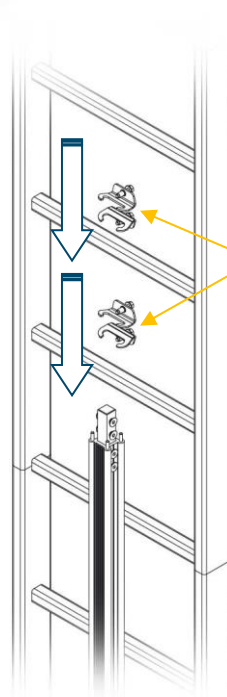



Distributed by

Vertical rail system

VERTIRAIL

5

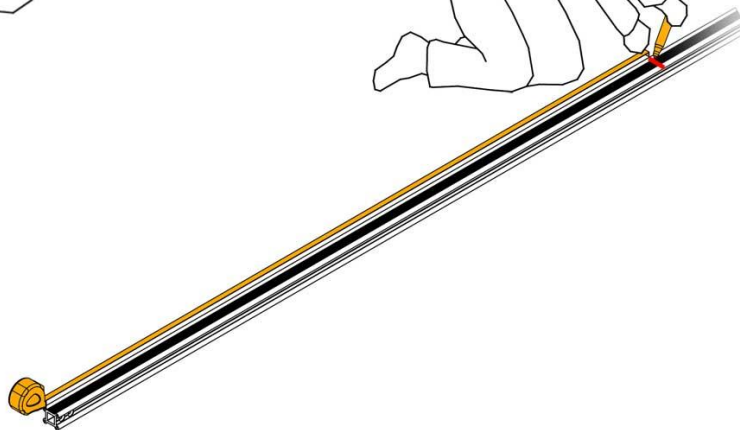
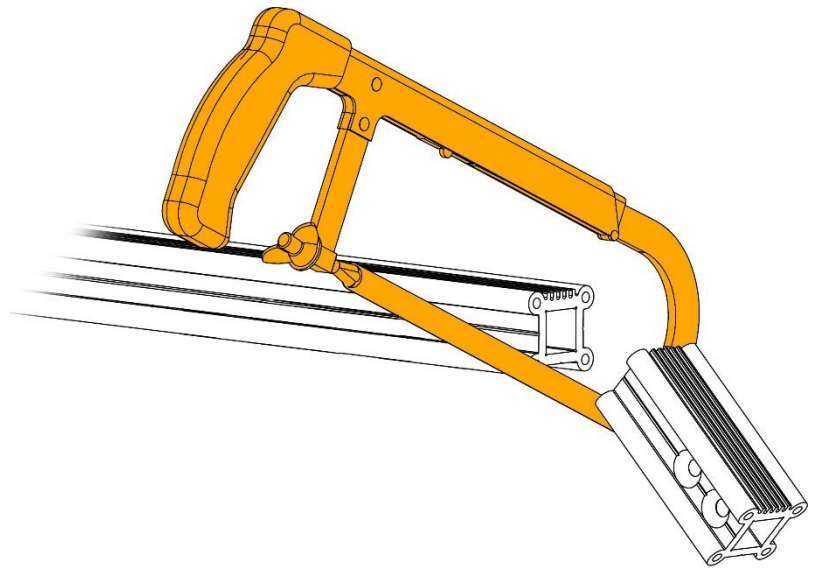
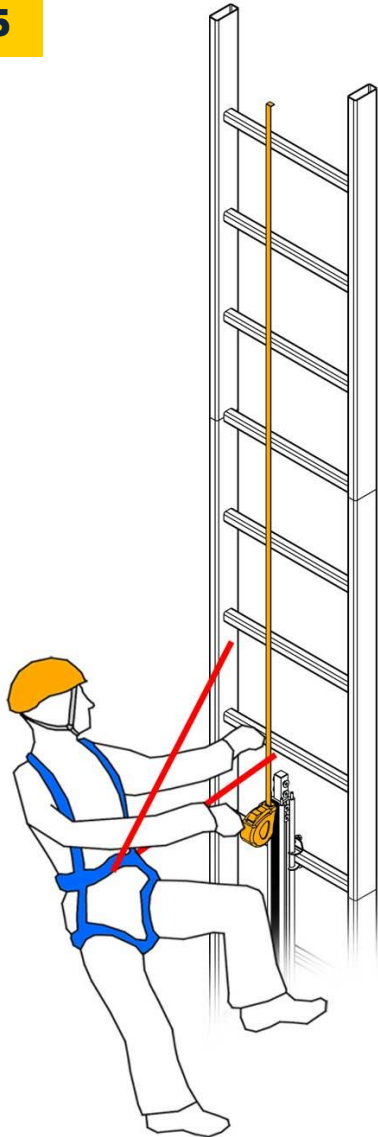



Distributed by

Vertical rail system

VERTIRAIL

6

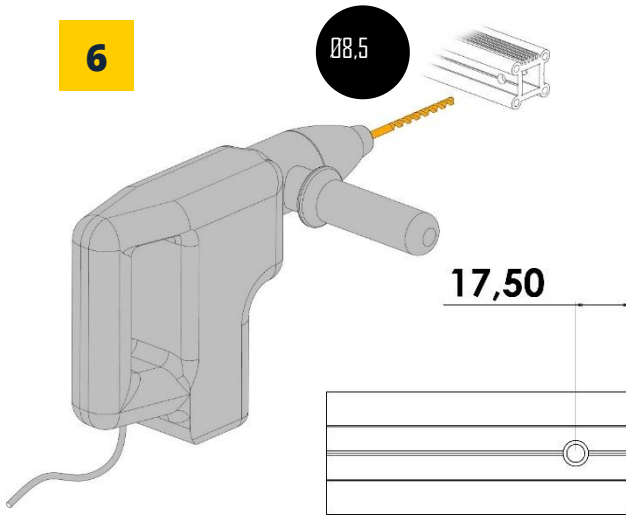

9

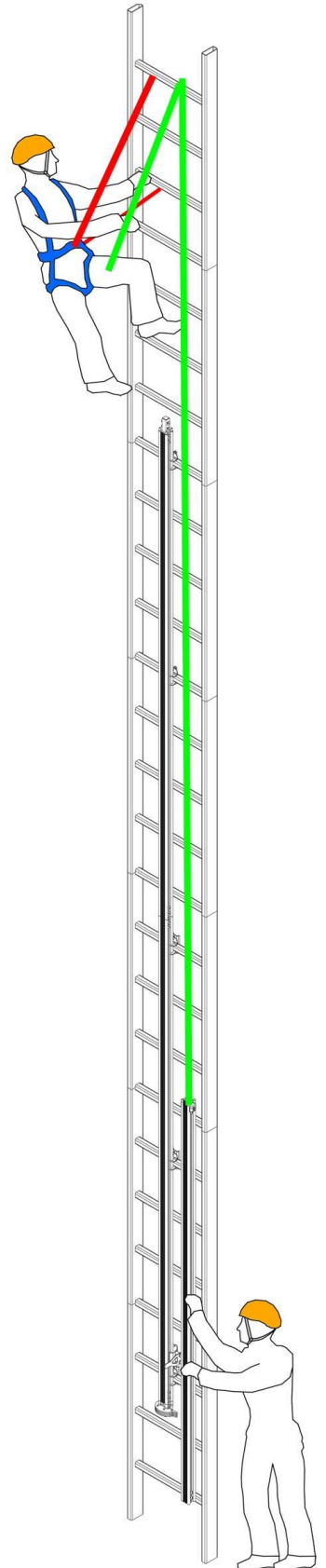

7

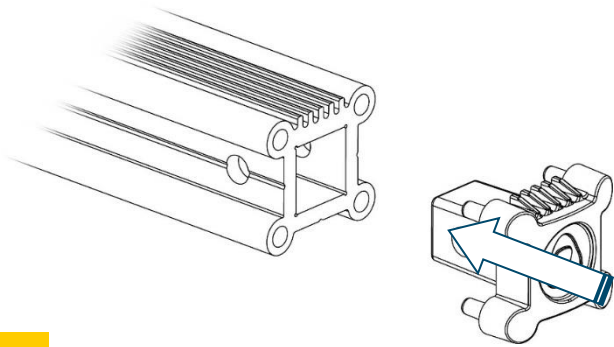

8

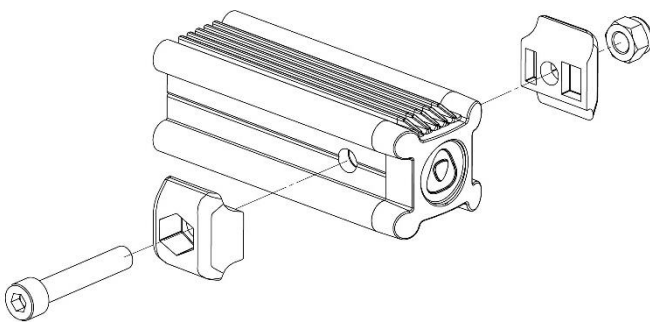



Distributed by

Vertical rail system

VERTIRAIL

10

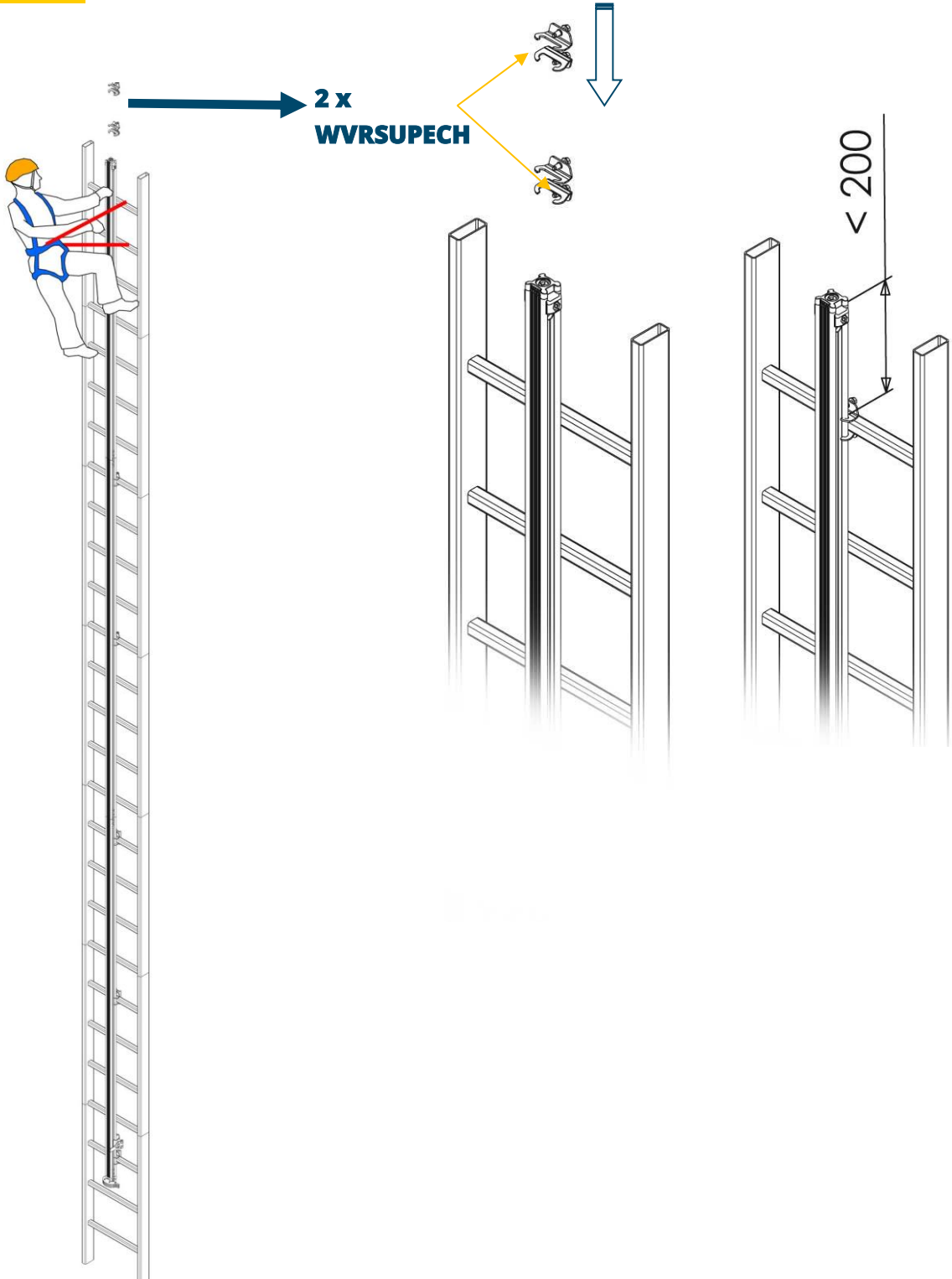



Distributed by

Vertical rail system

VERTIRAIL

11

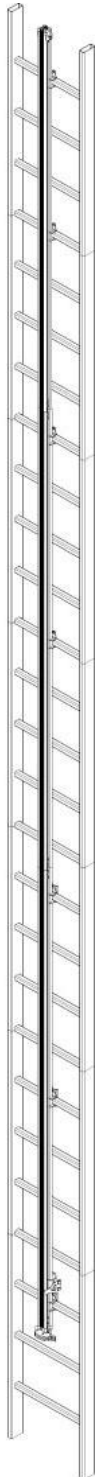

WVRPS

12

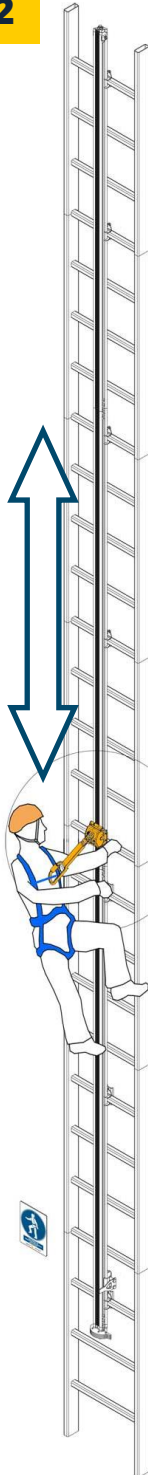

WVRCBV



Distributed by

Vertical rail system

VERTIRAIL



MOBILE RUNNER WRCBV

Product identification	
Manufacturer / Supplier :	Delta Plus Systems
Product name / Reference :	WRCBV mobile runner
Normative references :	EN 353-1: 2014 + A1: 2017

User identification			
Name :		Address:	
Historical verification			
Date of first use :		Date of purchase :	
Year of manufacture :		Serial number / Batch number :	

The controller accepts no responsibility for any inaccuracies in the information concerning the historical verification to be carried out by the user.

Service life / Disposal
<p>For Delta Plus Systems products, plastics and textiles, the maximum service life is 10 years from the date of manufacture. There is no limit for metal products. CAUTION, an exceptional event may lead you to reject a product after a single use (type and intensity of use, environment of use: aggressive environments, marine environment, sharp edges, extreme temperatures, chemicals, etc.).</p> <p>A product must be scrapped when :</p> <ul style="list-style-type: none"> - It is over 10 years old and made of plastic or textile, except for the seals, which need to be inspected regularly. - He has suffered a serious fall (or strain). - The results of the product checks are not satisfactory. You have doubts about its reliability. - You don't know its full history of use. - When its use is obsolete (changes in legislation, standards, technology or incompatibility with other equipment, etc.). <p>Destroy these products to prevent future use.</p>



Comments
 Good
 To watch out for
 Repaired
 To be discarded

Visual check of components					
Condition of the main body (cracks, marks, deformation, wear, corrosion)					
Condition of the shackle and its 2 pins (cracks, marks, deformation, wear, corrosion)					



Distributed by

Visual check of components					
Condition of the 4 rollers and their crimping (cracks, marks, deformation, wear, corrosion)					
Condition of the 4 friction rollers (cracks, marks, deformation, wear, corrosion)					
Textile absorber expiry date					
Condition of textile absorber and stainless steel shackle (deformation, wear, corrosion)					
Condition of snap hook (deformation, wear, corrosion, presence of clip)					
Condition of side guards (cracks, marks, deformation, wear)					
Presence of the identification label with normative information					
Condition of the protective cover and its 2 fixing screws (tightness, play)					

Functional verification of components					
180° tilting of the stainless steel shackle (no hard point)					
Good rolling of the 4 rollers (no hard spots, smooth running)					
Good rolling of the 4 friction rollers (no hard spots, smooth running)					
The carriage runs smoothly on a straight rail element					
The carriage runs smoothly on a curved rail element					
The carriage lock is operational					

Comments :	
Inspection verdict	
<input type="checkbox"/> The product is fit to remain in service	<input type="checkbox"/> The product is unfit to remain in service

Identification and visa of the controller			
Name :		Company	
Date of inspection :		Controller's stamp (Signature / Stamp) :	
Date of next inspection :			